

Please read carefully before use

Easy Fly **RTF**

ELECTRIC R/C MODEL PLANE READY TO FLY

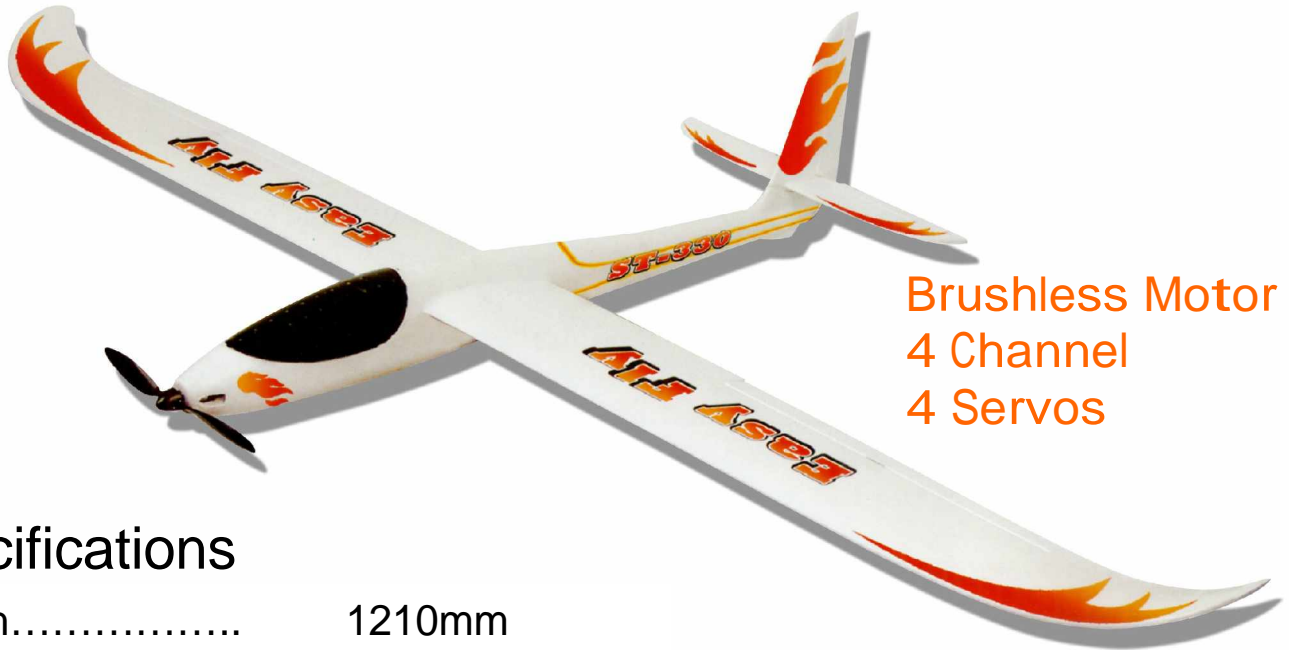

Brushless Motor
4 Channel
4 Servos

Specifications

Length.....	1210mm
Wing Span.....	1960mm
Wing Area.....	38.40dm
Wing Loading.....	25g/dm
Flying Weight.....	960g
Flying Time.....	15-30min (approx)

PRODUCT MANU AL

Safety Precautions

- * This electric R/C model plane is not a toy.
- * Skill level is designed for the intermediate pilot with some flying and building experience.
- * Children younger than 12 years old must use it accompanied by an adult
- * Please choose an open place to fly away from buildings and overhead power lines.
- * Please always put safety first and operate in a safe and reasonable manner.

Contents and Battery Charging

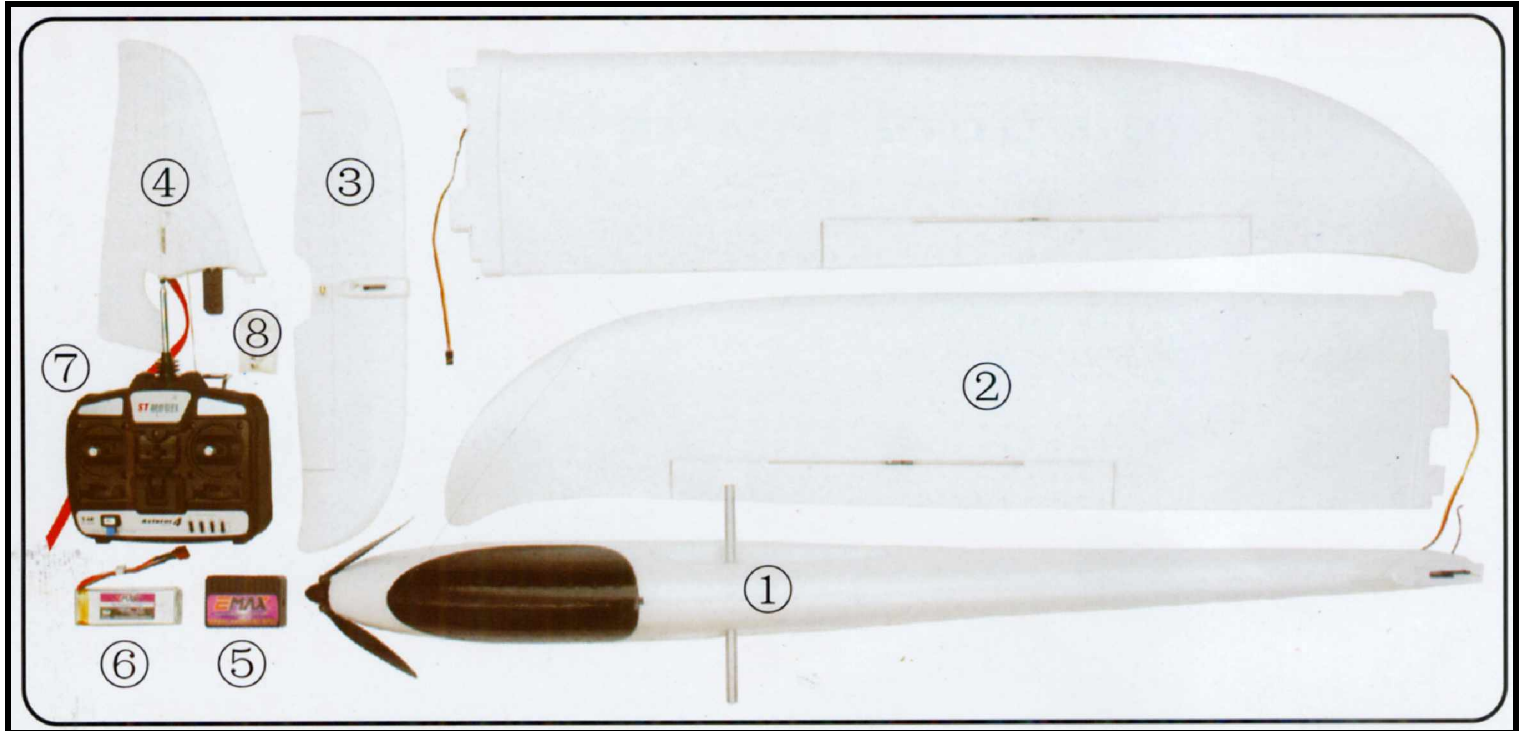

1. Body

3. Stabilizer

5. Charger

7. Transmitter

2. Wing

4. Fin

6. Li-Po Battery

8. Parts Bag

The battery must be fully charged before attempting to fly this model.

Battery Charging:

To charge the battery, connect the white lithium balance connector of the battery to your charger and connect the charger to a suitable 12v battery.

The green charging light will illuminate indicating that the battery is charging correctly. When the green light is no longer illuminated the battery is ready to use. Charging time will be approximately 2.5 hours, but this will vary depending upon the condition of the battery and the charge remaining in it at the time of charging.

Important Safety Note:

When charging the battery, it is important to keep battery and charger under observation and never to leave them unattended. Disconnect the battery from the charger when it has finished charging.

Assembly Instructions

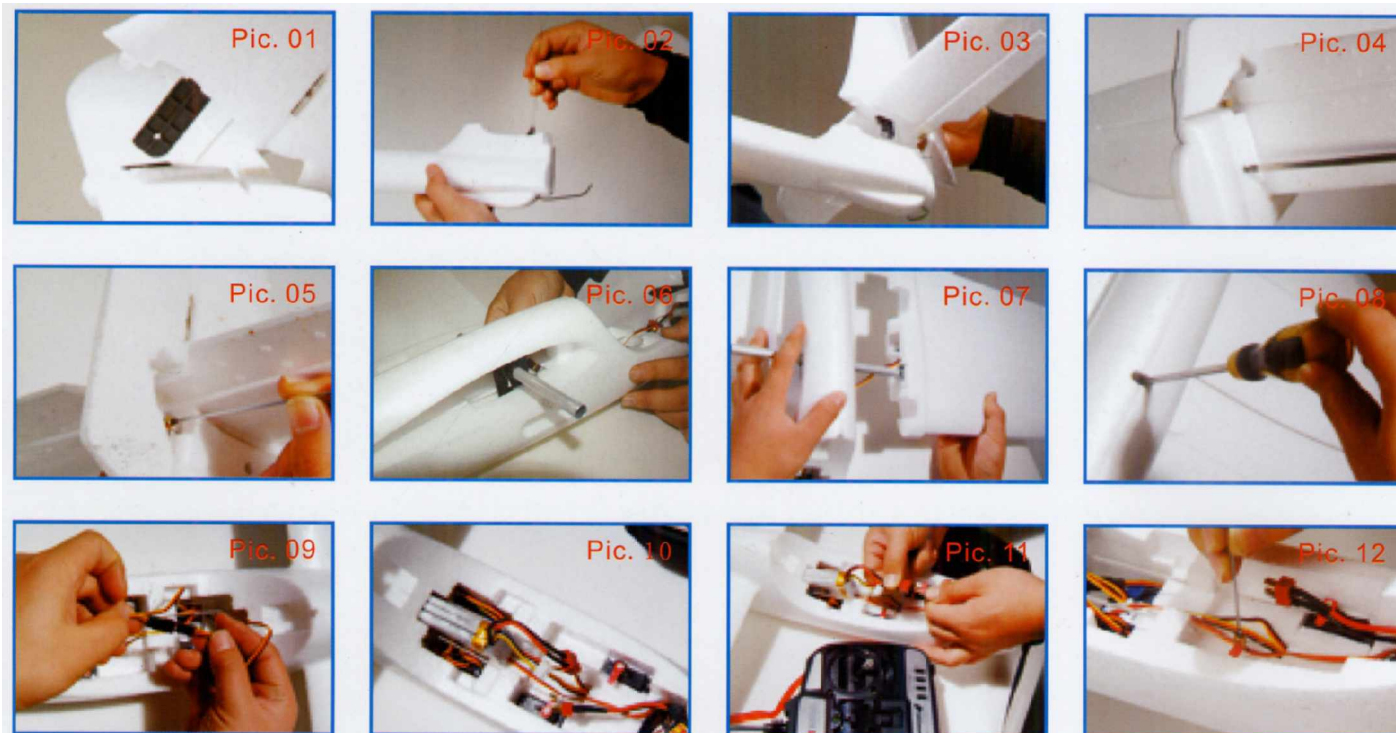

1. Remove the cable tie from the vertical fin/rudder to release the control cable. Insert the vertical fin/rudder into the plastic connecting piece in the centre of the tail plane (Pic #1) making sure that the control wire passes through the tail plane into the control cable's tube that protrudes from the tail section of the main fuselage (Pic #2)
2. Install the tail plane and fin/rudder assembly to the fuselage (Pic #3) and fix with cross head screw provided (Pic #4). Connect the rudder cable to the servo with grub screw provided.
3. Open canopy hatch and push through the control cable for the elevator. Fix the cable to the connector on the elevator using the grub screw provided (Pic #5). Connect the other end of this cable to the servo arm provided and fix the arm to the servo securely with the small servo screw making sure that the arm is centralised on the servo.
4. Take one wing and push the aileron servo wire through the fuselage into the radio bay (Pic #6). Push the wing onto the wing tube (Pic #7) and fix securely in place with the screw on the underside of the fuselage (Pic #8). Repeat for the other wing.
5. Take one of the aileron servo wires and connect to either of the servo extension leads (Pic #9).
6. Repeat for the other aileron servo wire.

Final Adjustments and Switching On

1. Switch on the transmitter making sure that the throttle stick and throttle trim tab is in the throttle off position (fully down). Centralise all the other trim tabs.
2. Insert the flight battery into the radio bay and connect the battery to the speed controller. You will hear one beep meaning that all is working well.
3. Check that the servos are centralised and make any minor adjustments to the servos and or control cables as necessary. The rudder and elevator surfaces should be centred after making these minor adjustments.
4. Replace canopy attached decals using box illustration as a guide and you are ready to fly.

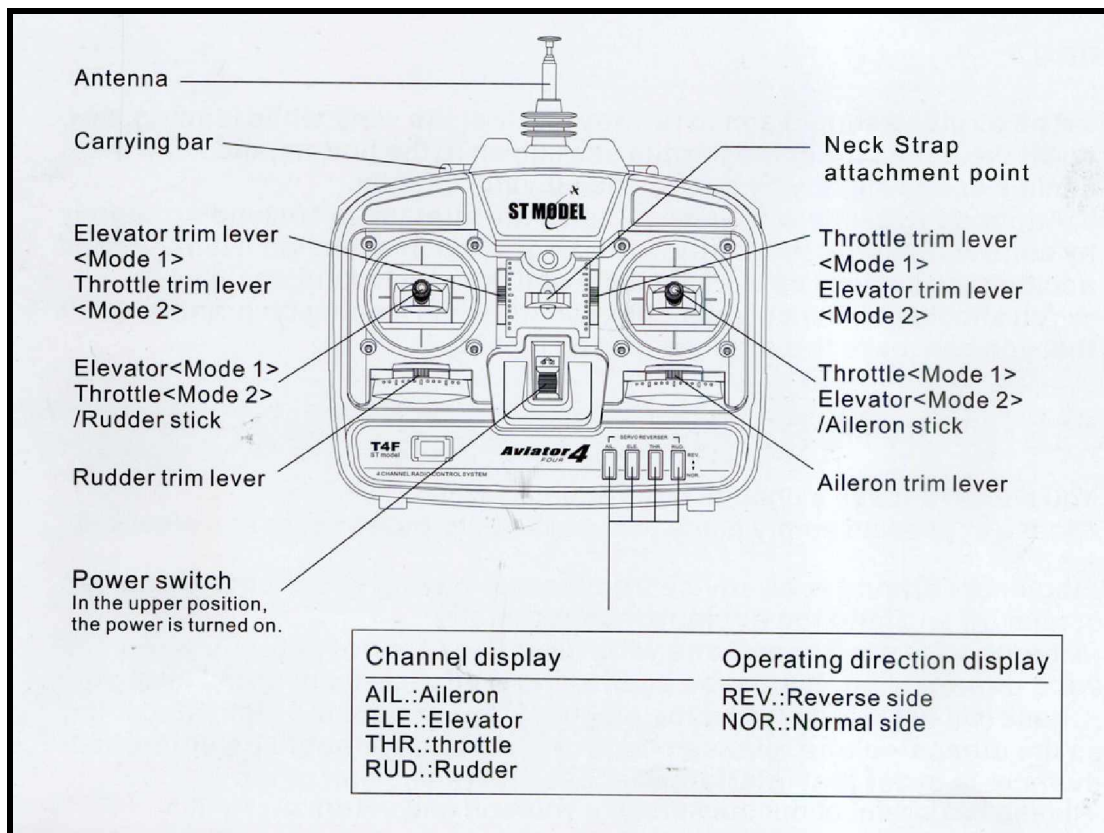

Beginners should seek help and advice from an experienced person. Choose an area large enough away from buildings, people, vehicles and overhead power lines. If other flyers are present make sure to check with them for frequencies in use to avoid interfering with their channel frequency. Remember that the radio supplied with this model is on 35Mhz FM frequency which is the official flying frequency that is used in the UK. Always check that your batteries are fresh and charged. After switching on your transmitter and model check that there is no interference. Do not fly in strong winds. Choose a fairly calm day for your first flight. Always disconnect your battery when not in use

We hope you have enjoyed assembling this model.
Happy Flying!